

# PLAT OF SURVEY

A number line representing distance in feet. The line starts at 0 and ends at 40, with major tick marks and labels at 0, 20, and 40. There are also minor tick marks at intervals of 5 units (5, 10, 15, 25, 30, 35). The segments of the line between 0 and 5, 10 and 15, 20 and 25, and 30 and 35 are shaded black. The word "Feet" is written at the right end of the line.

SCALE: 1'=20'

NOTE:

- NOTE:
1. BASIS OF BEARING: THE WISCONSIN STATE PLANE COORDINATE SYSTEM, NAD-83, SOUTH ZONE.
  2. FIELD WORK COMPLETED OCTOBER 15, 2020
  3. BUILDING SURVEYED TO THE EXTERIOR OF SIDING.
  4. FIELD CREW CHIEF: LOGAN RANDLE

**LEGAL DESCRIPTION:**

A PARCEL OF LAND LOCATED IN THE SOUTHEAST 1/4 OF THE NORTHWEST 1/4 OF SECTION 6 IN TOWNSHIP 1 NORTH, RANGE 17 EAST, IN THE VILLAGE OF WILLIAMS BAY, WALWORTH COUNTY, WISCONSIN, MORE PARTICULARLY DESCRIBED AS:

LOTS 1 AND 2 OF BLOCK 3 OF THE HARBOR VIEW SUBDIVISION, AS  
RECORDED IN DOCUMENT # P247077 AT THE WALWORTH COUNTY REGISTER  
OF DEEDS.

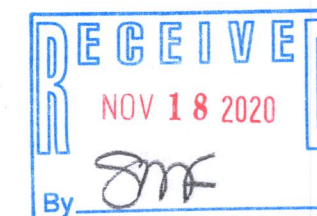

SURVEY ORDERED BY:

JOSEPH BALSITIS

PROPERTY ADDRESS:

647 E GENEVA ST  
WILLIAMS BAY, WI 53191

SURVEYOR:

PAUL H. VAN HENKELUM, PLS  
CARDINAL ENGINEERING LLC

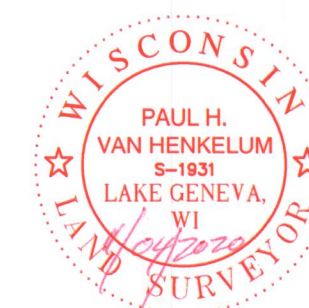

"I HEREBY CERTIFY THAT I HAVE SURVEYED THE ABOVE DESCRIBED PROPERTY AND THE MAP IS A TRUE AND CORRECT REPRESENTATION OF ITS EXTERIOR BOUNDARIES AND SHOWS THE SIZE AND LOCATION OF ALL VISIBLE STRUCTURES, APPARENT EASEMENTS AND ENCROACHMENTS, IF ANY."

PAUL H VAN HENKELUM, PLS #1931

DATE \_\_\_\_\_



CARDINAL ENGINEERING LLC  
DESIGNING IN TRUE DIRECTIONS

PO BOX 281 - 1200 LA SALLE ST.  
LAKE GENEVA, WI 53147  
262-757-8776

CARDINALENGINEERINGWI.COM

DATE: 11/2/2020 JOB No. 20486 JBM  
SHEET 1 OF 1

011-2974

WHV-35